



Valued Quality. Delivered.

# Code Compliance Research Report CCRR-1039

Issue Date: 04-29-2015  
Revision Date: 01-01-2018  
Renewal Date: 01-01-2019

## DIVISION: 06 00 00 – WOOD, PLASTICS, AND COMPOSITES

### Section – 06 53 00 – Plastic Decking

#### REPORT HOLDER:

Gracious Living Innovations Inc.  
151 Courteny Park Drive West  
Mississauga, Ontario  
L5W 1Y5 Canada  
(905) 795 5505  
<http://www.glinnov.com/>

#### REPORT SUBJECT:

AURA® Decking Deck Boards:  
Ultraboard  
Ultraboard Bullnose

### 1.0 SCOPE OF EVALUATION

This Research Report addresses compliance with the following Codes:

- 2015 and 2012 *International Building Code*® (IBC)
- 2015 and 2012 *International Residential Code*® (IRC)

The products described in this report have been evaluated for the following properties:

- Structural Performance
- Durability
- Surface Burning
- Decay Resistance
- Termite Resistance

### 2.0 USES

AURA® Decking Deck Boards are intended for use as a walking surface on exterior decks, balconies, porches, and walkways, including stairs.

### 3.0 DESCRIPTION

AURA® Decking Deck Boards have sculpted bottom cross-sections, and grooved edges. The deck boards are supplied in two configurations: Ultraboard and Ultraboard Bullnose, and are available in Cedar, Chestnut, and Costal Grey colors. See Tables 1a and 1b and Figure 1.

Ultraclip Fastening Clips are injection molded thermoplastic clips provided for hidden attachment of the deck boards to supports. See Tables 1a and 1b, and Figure 2 and 3.

### 4.0 PERFORMANCE CHARACTERISTICS AND INSTALLATION

#### 4.1 Performance Characteristics:

**4.1.1** Uniform Live Load ratings are given in Table 2 for the corresponding deck boards and fasteners indicated.

**4.1.2** Deck boards used as stair treads are rated for the code-prescribed concentrated load equal to 300 lb. when installed with a maximum span indicated in Table 3. Deck boards used as stair treads must be installed in a minimum two-span condition.

**4.1.3** Wind uplift resistance ratings are given in Table 2 for the corresponding deck boards and fasteners indicated.

**4.1.4** AURA® Decking Deck Boards have a flame spread index of 175 when tested in accordance with ASTM E84. The referenced criterion, AC174, requires a flame spread index not exceeding 200.

**4.1.5** Materials used are deemed equivalent to preservative treated or naturally durable wood for resistance to weathering effects, attack from Eastern subterranean termites, and fungus decay.

**4.1.6** Structural performance has been demonstrated for a temperature range from -20°F to 125°F.

#### 4.2 Installation:

Installation shall be in accordance with the manufacturer's installation instructions and this report. Where differences occur between this report and the manufacturer's installation instructions, this report governs.



545 E. Algonquin Road • Arlington Heights • Illinois • 60005  
[intertek.com/building](http://intertek.com/building)



**4.2.1** The Ultraboard deck boards must be secured at each joist with Ultraclip Fastening Clips (specified in Table 2). Where a final row of clips against perimeters cannot be used, pre-drill and screw deck board into joist from top surface. Attach the deck board with screws spaced 36 inches apart. To avoid complications from expansion/contraction, all holes, except the center hole, must be slotted.

**4.2.2** The grooved edge side of the Ultraboard Bullnose sculpted bottom deck boards must be secured with Ultraclip Fastening Clips (specified in Table 2) at each joist. The nosing face must be face-fastened to supporting structure.

**4.2.3** Table 2 indicates type of fasteners that are to be used for each installation.

## 5.0 CONDITIONS OF USE

The AURA® Decking Deck Boards identified in this report are deemed to comply with the intent of the provisions of the referenced Building Codes subject to the following conditions:

**5.1** Installation must comply with this Research Report, the manufacturer's published installation instructions, and the applicable Code. In the event of a conflict between the manufacturer's instructions and this report, this report governs.

**5.2** The deck boards are limited to use in Type V-B construction.

**5.3** Deck boards placed at an angle other than 90 degrees to the supporting joist require support framing at a reduced spacing, such that the span of the deck board does not exceed the span identified in Table 2.

**5.4** The wind uplift resistance rating recognized in this report is based on attachment to No. 2 Structural Grade Spruce-Pine-Fir (SPF). Installation on wood framing with a lesser grading may result in a lower wind uplift rating.

**5.5** Compatibility of the metal fasteners, metal post mount components, and other hardware with the supporting structure, including chemically-treated wood, is outside the scope of this report and is subject to approval by the Code official.

**5.6** Where required by the building official, engineering calculations and details shall be provided. The calculations shall verify that the anchorage complies with the Building Code for the type of framing and condition of the supporting construction.

**5.7** The deck boards are manufactured in Mississauga, Ontario, Canada, in accordance with the manufacturer's approved quality control system under a quality control program with inspections by Intertek Testing Services NA, Inc. (AA-647).

## 6.0 SUPPORTING EVIDENCE

**6.1** Manufacturer's drawings and installation instructions.

**6.2** Reports of testing demonstrating compliance with ICC-ES AC174, Acceptance Criteria for Deck Board Span Ratings and Guardrail Systems (Guards and Handrails), dated January 2012 (editorially revised December 2014).

**6.3** Reports of testing and engineering analysis demonstrating compliance with the performance requirements of ASTM D7032-10a, Standard Specification for Establishing Performance Ratings for Wood-Plastic Composite Deck Boards and Guardrail Systems (Guards or Handrails).

**6.4** Quality documentation.

**6.5** Intertek Listing Report [Gracious Living Innovations - AURA Decking](#).

## 7.0 IDENTIFICATION

AURA® Decking Deck Boards shall be identified with labeling on the individual deck boards that includes the name and/or trademark of the manufacturer; the Research Report number (CCRR-1039) and the Intertek Mark.

## 8.0 OTHER CODES

This section is not applicable.

## 9.0 CODE COMPLIANCE RESEARCH REPORT USE

**9.1** Approval of building products and/or materials can only be granted by a building official have legal authority in the specific jurisdiction where approval is sought.

**9.2** Code Compliance Research Reports shall not be used in any manner that implies an endorsement of the product by Intertek.

**9.3** Reference to the Intertek internet website address at <https://bpdirectory.intertek.com> is recommended to ascertain the current version of status of this report.

This Code Compliance Research Report ("Report") is for the exclusive use of Intertek's Client and is provided pursuant to the agreement between Intertek and its Client. Intertek's responsibility and liability are limited to the terms and conditions of the agreement. Intertek assumes no liability to any party, other than to the Client in accordance with the agreement, for any loss, expense or damage occasioned by the use of this Report. Only the Client is authorized to permit copying or distribution of this Report and then only in its entirety, and the Client shall not use the Report in a misleading manner. Client further agrees and understands that reliance upon the Report is limited to the representations made therein. The Report is not an endorsement or recommendation for use of the subject and/or product described herein. This Report is not the Intertek Listing Report covering the subject product and utilized for Intertek Certification and this Report does not represent authorization for the use of any Intertek certification marks. Any use of the Intertek name or one of its marks for the sale or advertisement of the tested material, product or service must first be approved in writing by Intertek.



545 E. Algonquin Road • Arlington Heights • Illinois • 60005  
[intertek.com/building](http://intertek.com/building)



**Table 1a – AURA® Decking Deck Boards Product Description**

Decking Plank	Description	Surface Descriptions	Color(s)
Ultraboard	1.250" x 5.5" Sculpted Bottom Grooved Edges	Textured with Embossed Wood Pattern	Cedar, Chestnut and Coastal Grey <sup>1</sup>
Ultraboard Bullnose	1.875" x 6" Sculpted Bottom with Grooved Edges	Textured with Embossed Wood Pattern	

<sup>1</sup> Coastal Grey colored plank surface is treated with a coating to provide additional color protection under exposure to ultra-violet light.

**Table 1b – AURA® Decking Deck Boards Product Description**

Product	WPC Core	PVC Core	Plastic Core <sup>1</sup>	WPC Cap	Polymer Cap <sup>2</sup>	PVC Cap	Full Cap	Semi Cap	Co-Extruded	Mono-Extruded
Ultraboard			X		X			X	X	
Ultraboard Bullnose			X							X

<sup>1</sup> Plastic Core is comprised of polystyrene with flame retardant.

<sup>2</sup> Polymer Cap is comprised of polystyrene with flame retardant.

**Table 2 – AURA® Decking Ratings**

Decking Plank	Deck Board Span/Load Rating <sup>1</sup>	Stair Tread Span/Load Rating <sup>2</sup>	Fastener <sup>3</sup>	Wind Uplift Resistance <sup>3</sup>
Ultraboard	16/100	12/100	Ultraclip Hidden Fastening Clip with No. 8 x 2 inch (51mm) square or Phillips head stainless steel screw	107 psf
Ultraboard Bullnose	Not used as Deck Board	12/100 <sup>4</sup>	Ultraclip Hidden Fastening Clip with No. 8 x 2 inch (51mm) square or Phillips head stainless steel screw, on grooved edge. No. 8 x 2 inch deck screws every 24 inches through pre-drilled and counter-sunk holes on lower lip of front face	107 psf

<sup>1</sup> Span/Load rating is the maximum span in inches and the maximum allowable live load in pounds per square foot (psf).

<sup>2</sup> Stair tread span in inches is based on a continuous deck board over two or more equal spans (3 supports).

<sup>3</sup> Wind uplift resistance in pounds per square foot (psf) is based on two fasteners at each support (wood joist) except Grooved Edge Boards which use one hidden fastener located at each joist. Values have been adjusted for wind load duration and end use. No further adjustments shall be made.

<sup>4</sup> The nosing of the Ultraboard Bullnose plan is supported by No. 2 Structural Grade Spruce-Pine-Fir (SPF).

**Figure 1 – AURA® Decking Deck Boards**

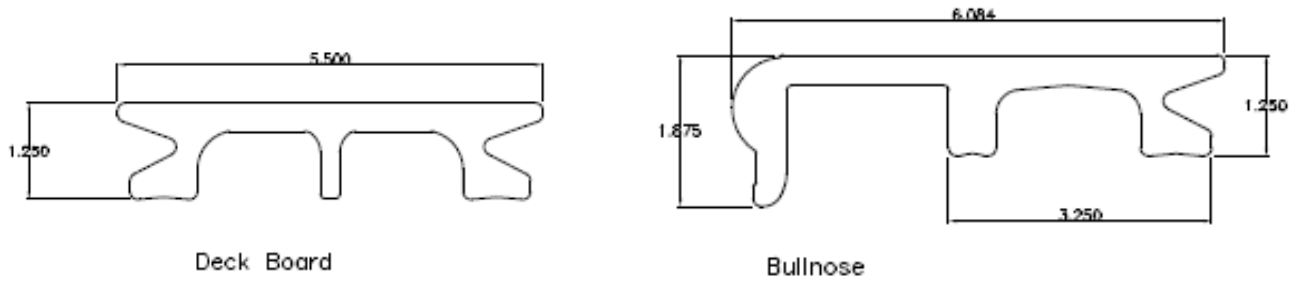

**Figure 2 – Ultraclip Hidden Fastener Clip**

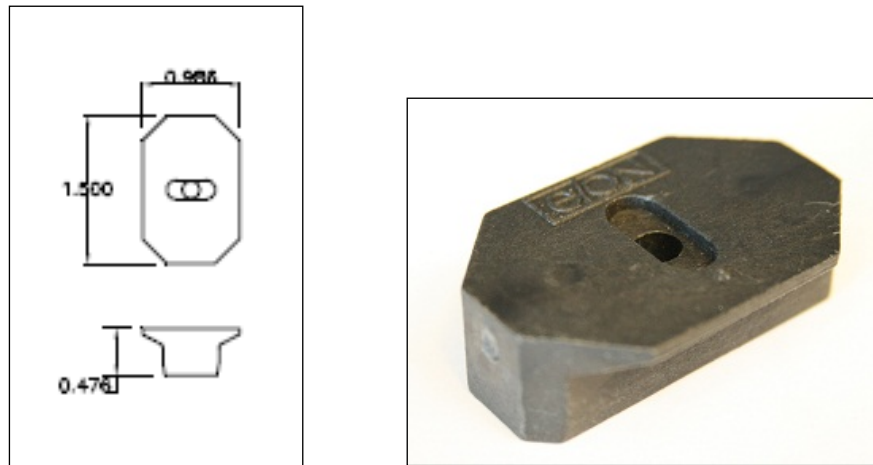

**Figure 3 – Stair Tread Installation**

